

SECTION A - A  
PHASE 1 REINSTATEMENT  
SCALE 1: 10

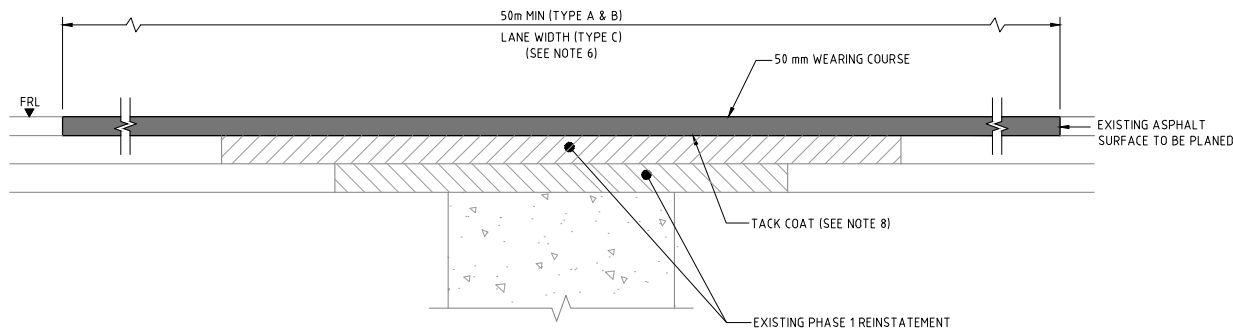

SECTION A - A  
PHASE 2 REINSTATEMENT  
SCALE 1: 10

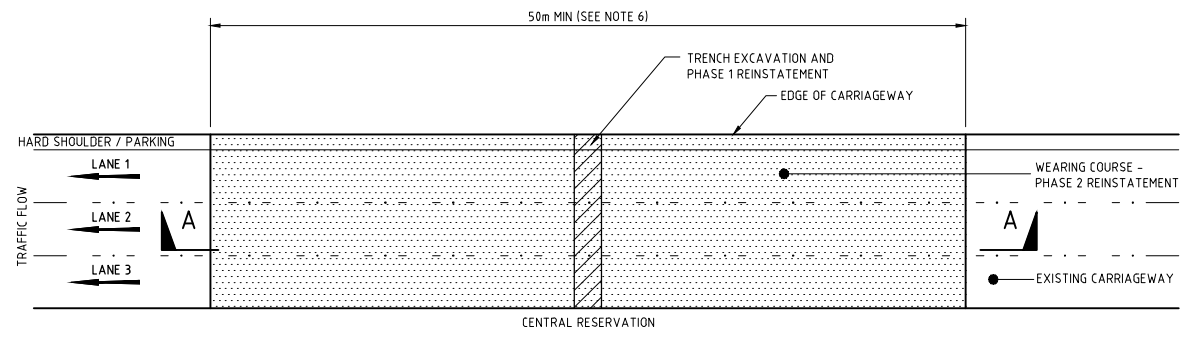

PLAN VIEW  
TYPICAL REINSTATEMENT - TYPE A  
SCALE 1: 250

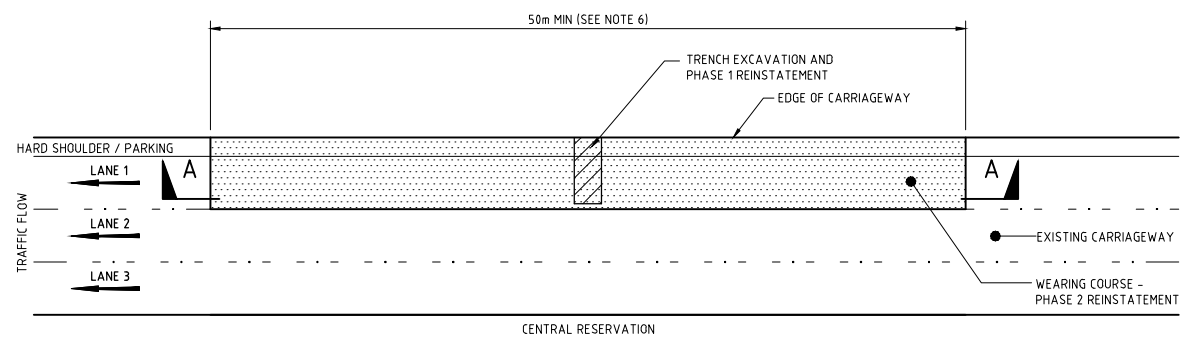

PLAN VIEW  
TYPICAL REINSTATEMENT - TYPE B  
SCALE 1: 250

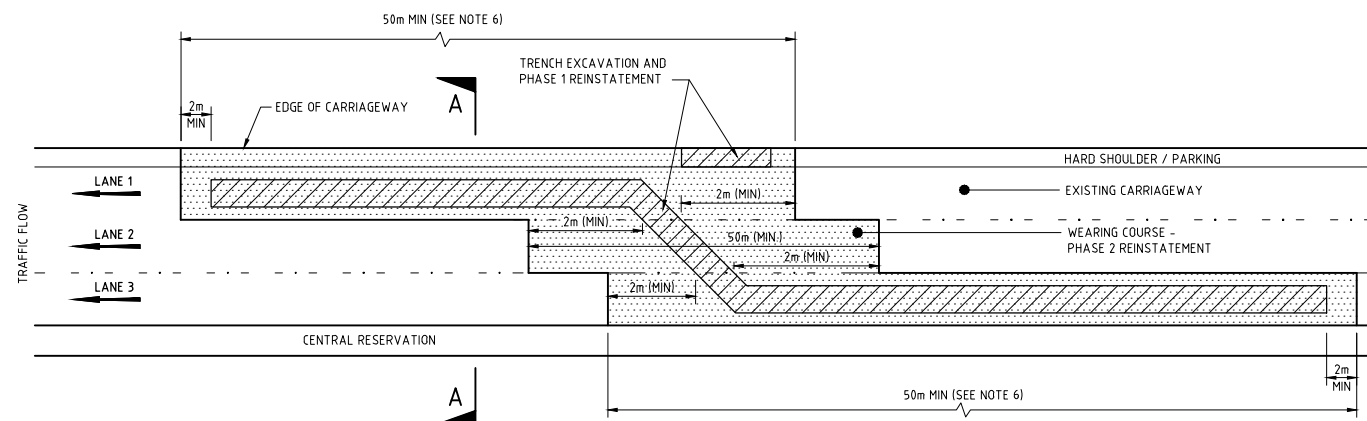

PLAN VIEW  
TYPICAL REINSTATEMENT - TYPE C (LONGITUDINAL)  
SCALE 1: 250

#### NOTES:

##### PHASE 1 REINSTATEMENT:

- FOR TRENCH WIDTH OF 15m OR LESS ALL BACKFILL WITHIN 1 METER FROM THE FINISHED ROAD LEVEL (FRL), SHALL BE:
  - CONTROLLED LOW STRENGTH MATERIAL (CLSM) (0.3 N/mm<sup>2</sup> TO 2.5 N/mm<sup>2</sup>).
  - OR FOAM CONCRETE (5 N/mm<sup>2</sup>).
  - OR FTB-FLUIDIZED THERMAL BACKFILL (5 N/mm<sup>2</sup>).
  - OR SRC 20 CONCRETE FOR SHALLOW TRENCH WITH SRC 20 UTILITY SURROUND.

AS DIRECTED BY THE ENGINEER, (UP TO THE BOTTOM OF BASE COURSE LEVEL). THIS INCLUDES AREAS AROUND MANHOLES.

- FOR BACKFILL BELOW 1 METER FROM FRL, SELECTED FILL MATERIALS SHALL BE USED IN CONFORMANCE WITH QCS.
- FOR TRENCH WIDTH GREATER THEN 15m, BACKFILL MATERIALS USED SHALL BE IN CONFORMANCE WITH QCS.
- ALL SERVICE UTILITIES UNDER THE CARRIAGEWAY SHALL BE SURROUNDED IN ACCORDANCE WITH THE "TYPICAL REINSTATEMENT CROSS SECTION", WITH THE FOLLOWING OPTIONS:
  - CONCRETE SRC 20 SURROUND FOR DUCTS (INCLUDING ORODOO).
  - BEDDING MATERIALS FOR DRAINAGE AND WATER PIPES.
  - OR AS PER SERVICE AUTHORITY STANDARD DETAILS.

- 150 mm BASE COURSE WITH A MINIMUM WIDTH OF 1 METER, IS TO BE LAID IN TWO LAYERS OF 75mm EACH IF EXISTING BASE COURSE IS MORE THAN 150mm, USE THE EXISTING BASE COURSE THICKNESS.

##### PHASE 2 REINSTATEMENT:

- THE MINIMUM LENGTH OF LONGITUDINAL PHASE 2 REINSTATEMENT (WEARING COURSE), FOR ANY ROAD CUTTINGS, SHALL BE 50 METERS. THE MINIMUM WIDTH (TRANSVERSE) SHALL COVER THE FULL WIDTH OF THE TRAFFIC LANE, PARKING LANE, OR HARD SHOULDER AFFECTED.
- ALL BITUMINOUS REINSTATEMENT SHALL BE MACHINE LAID, JOINTS SHALL BE VERTICAL AND SAW CUT, AND USING ONLY APPROVED CLASS A ROAD CONTRACTORS.

##### GENERAL:

- ALL SURFACES SHALL BE FREE OF CONTAMINATION PRIOR TO APPLICATION OF TACK COAT.
- CARE TO BE TAKEN WHEN CUTTING SURFACE LAYERS TO AVOID DAMAGE TO RUNNING SURFACE. CUTTING SHALL BE BY USE OF ASPHALT SAW AND OR PLANER.
- CUTBACK CONSTRUCTION JOINTS SHALL NOT BE WITHIN WHEEL PATHS (TYPE C).
- MAJOR ROADS ARE DEFINED AS ROADS WITH 2 OR MORE LAYERS OR COURSES OF ASPHALT COMPRISING OF A WEARING COURSE AND A BASE COURSE.
- PHASE 1 REINSTATEMENT SHALL BE BROUGHT TO FRL WITH A TEMPORARY LAYER OF ASPHALT PRIOR TO OPENING TO TRAFFIC UNLESS PHASE 2 REINSTATEMENT IS CARRIED OUT SIMULTANEOUSLY WITH PHASE 1.

#### REFERENCES:

- AMENDMENT TO THE CODE OF PRACTICE AND SPECIFICATION FOR ROAD OPENING IN THE HIGHWAY.

| Rev. | Date    | Revision Details | Appd. |
|------|---------|------------------|-------|
| 1    | 20MAR16 | ISSUED FOR USE   |       |
| 0    | 07DEC14 | ISSUED FOR USE   |       |

هيئة الأشغال العامة  
Public Works Authority

P.O. Box: 22188  
Tel.: 00974 44950000  
Fax: 00974 44950999

قطر تستحق الأفضل  
Qatar Deserves The Best

**AA**  
ASSET AFFAIRS

www.ashghal.gov.qa

QCS Section:  
Section 6 - Road Works  
Part 1 - General

Drawing Title:

REINSTATEMENT DETAILS  
MAJOR ROADS  
(3 LANES OR MORE )

|                            |                  |
|----------------------------|------------------|
| Approved:                  | Sheet No: 1 OF 1 |
| Date: MARCH 2015           | Scale: AS SHOWN  |
| Drawing Number: SD 6-1-201 | Revision: 1      |