

ISOMETRIC VIEW

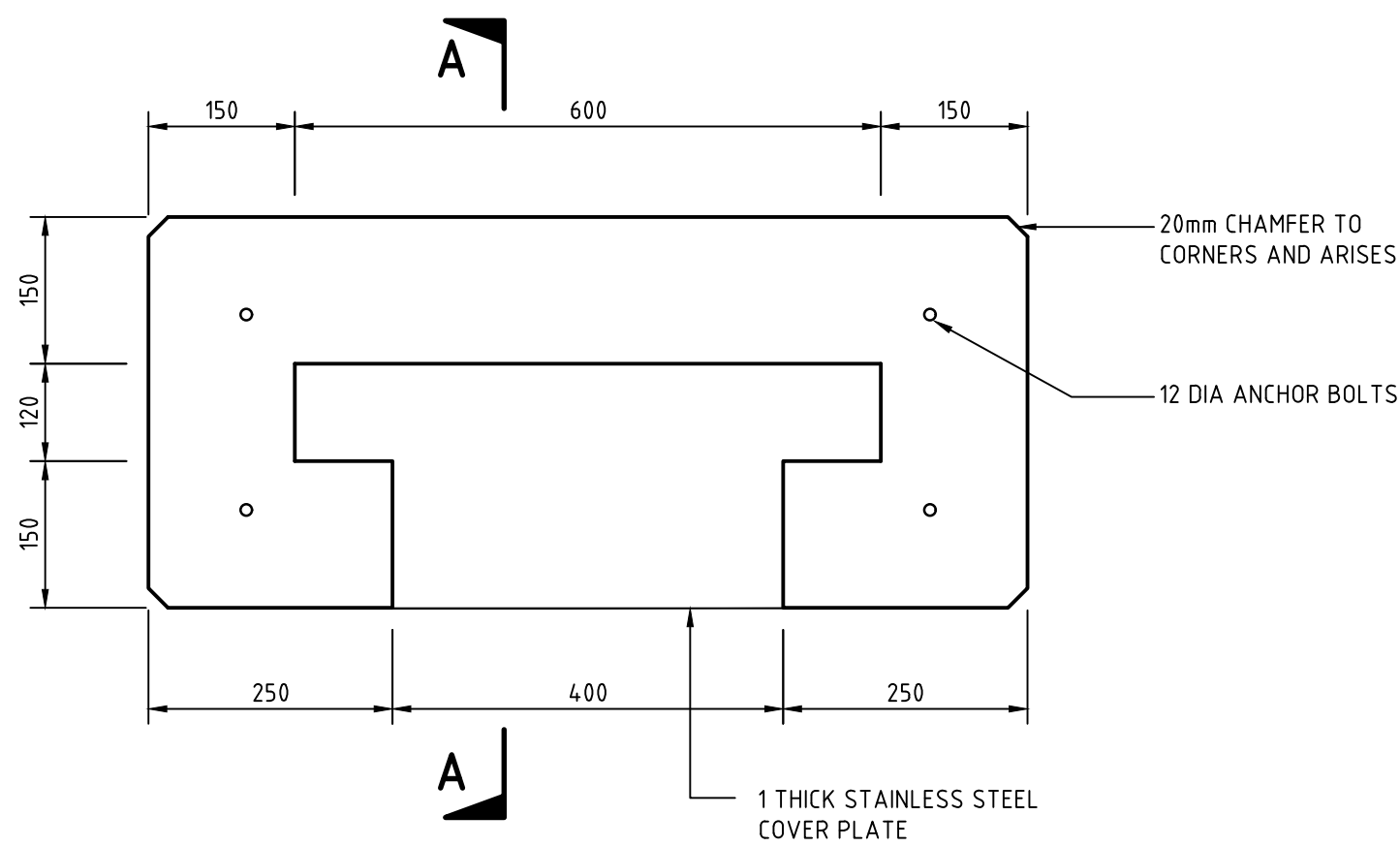

PLAN

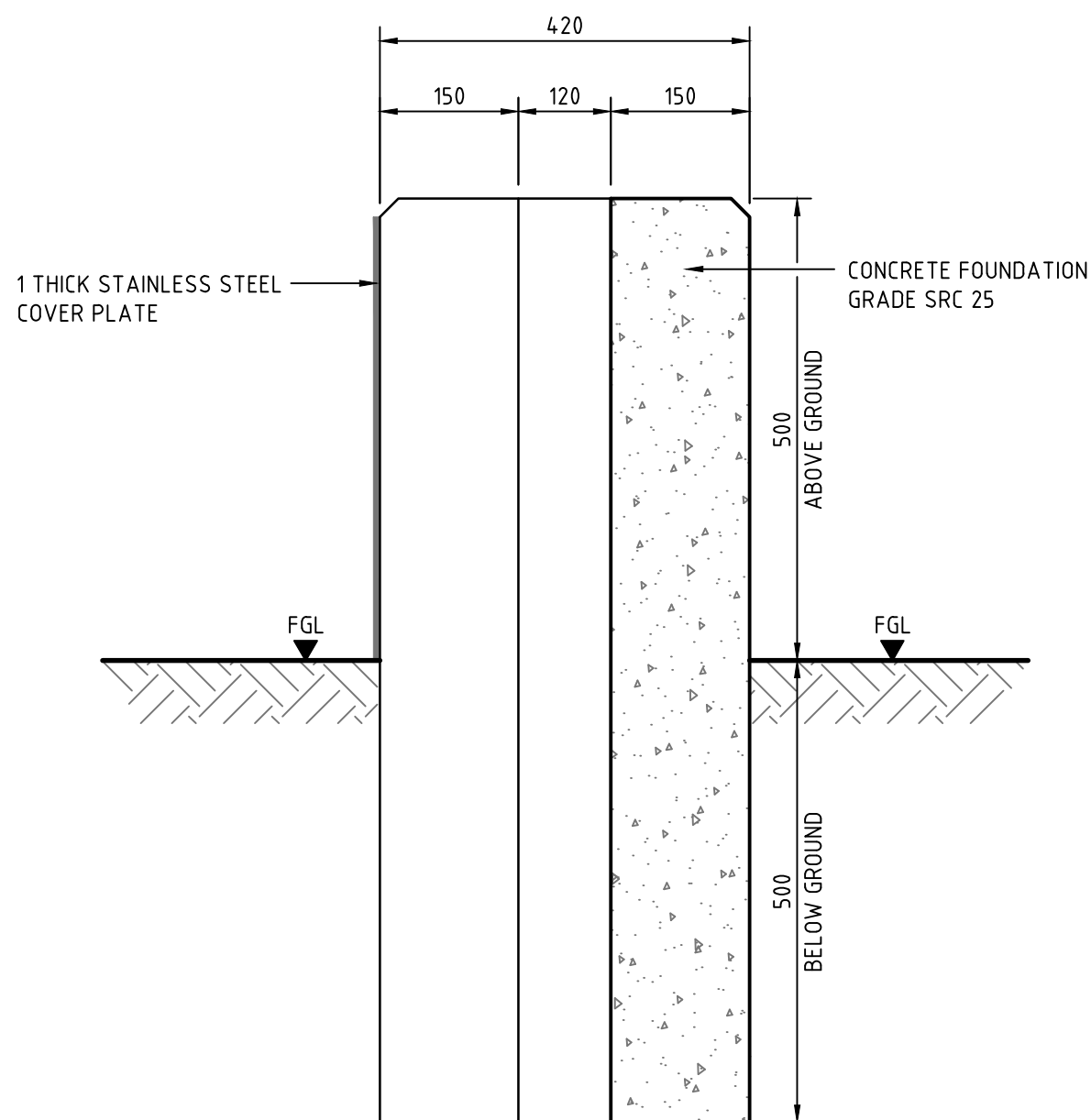

SECTION A -A

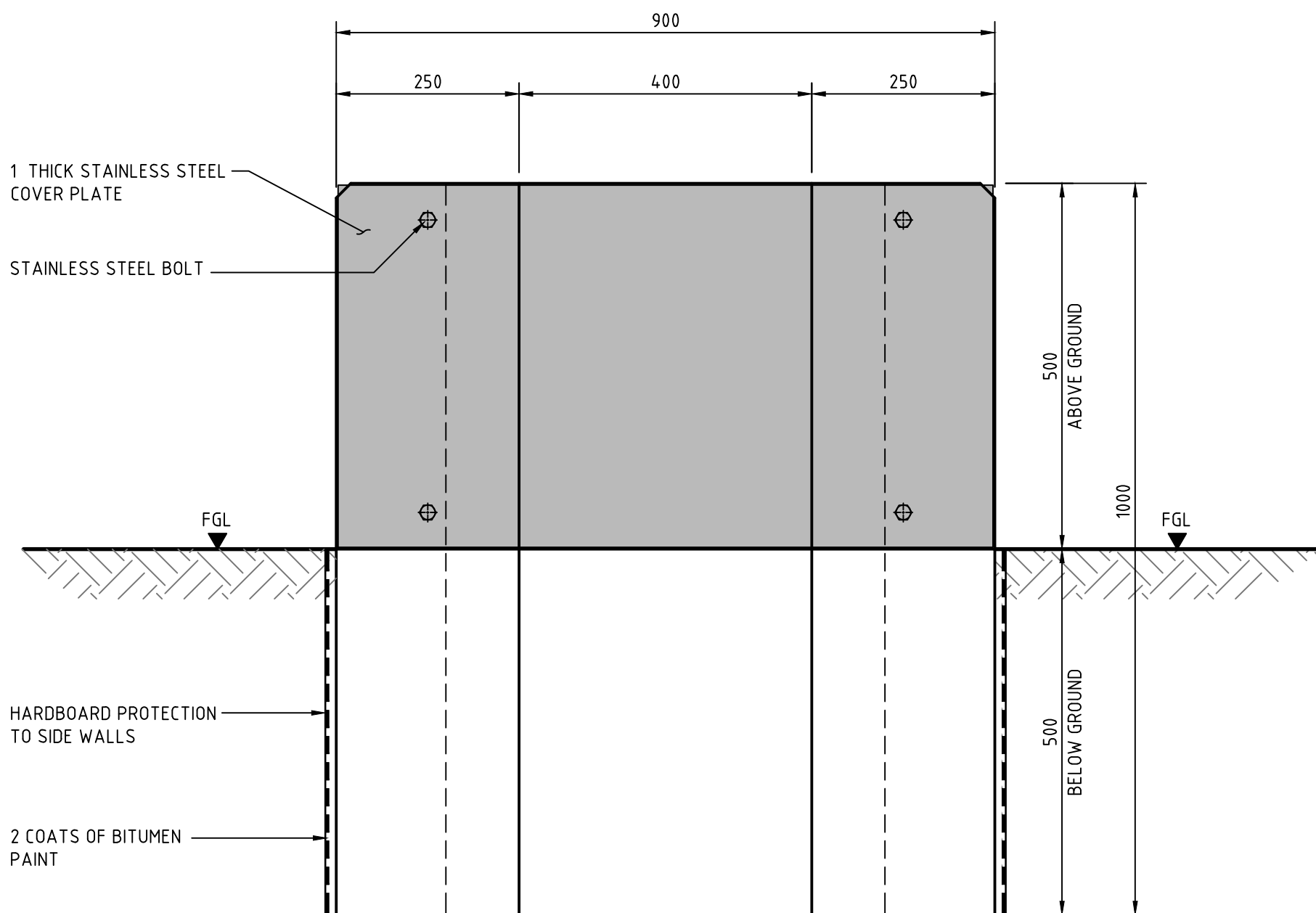

ELEVATION

NOTES:

1. ALL DIMENSIONS ARE IN MILLIMETRES UNLESS OTHERWISE STATED.
2. ALL MATERIALS AND WORKMANSHIP SHALL BE IN ACCORDANCE WITH THE CURRENT Q.C.S. UNLESS OTHERWISE AGREED WITH THE ENGINEER.
3. DIMENSIONS SHOWN ARE INDICATIVE. THE FINAL DIMENSIONS OF THE FEEDER PILLAR FOUNDATION SHALL BE AS PER THE MANUFACTURER'S REQUIREMENTS.

2	24SEP24	ISSUED FOR USE	
1	20MAR16	ISSUED FOR USE	
0	15SEP13	ISSUED FOR USE	
Rev.	Date	Revision Details	Appd.

هيئة الأشغال العامة
Public Works Authority

P.O.Box 22188
Tel.: (0974) 44950000
Fax.: (0974) 44950999
www.ashghal.gov.qa



قطر تستحق الأفضل
Qatar Deserves The Best

PA
PROJECTS AFFAIRS

QCS Section:
Section 6 - Road Works
Part 15 - Road Lighting

Drawing Title:

FEEDER PILLAR
FOUNDATION DETAILS

Approved:	Sheet No: 1 OF 1		
Date: MARCH 2016	Scale: N.T.S.		
Drawing Number: SD 6-15-1502			Revision: 2