

SECTION-A-A

NEW HEAVY DUTY GRADE 'A' DUCTILE IRON, DOUBLE TRIANGULAR MANHOLE COVER AND FRAME 750x750 DIA CLEAR OPENING - BEDDED IN CEMENT MORTAR COMPLETE WITH GRP SEALING PLATE

TANKING AND TANKING PROTECTION

PROPOSED WORK
EXISTING STRUCTURE

EXISTING CONCRETE SURROUND IF ANY TO BE SCABBLED TO RECEIVE NEW GRADE SRC '20' CONCRETE SURROUND

EXISTING JOINTS TO BE SEALED BY APPROVED METHOD

A

LINER SPACER

GRP LAMINATE

PIPE DIA

SR CONCRETE BENCHING

MASS CONCRETE

CONCRETE BLINDING

250 CHAMBER RING DIA 250

SHALLOW MANHOLE

NEW GRADE SRC 20 CONCRETE SURROUND

NEW GRADE SRC 50 PRECAST CONCRETE COVER SLAB

PREFORMED 7 THICK GRP LINER TO INCORPORATE STRENGTHENED LIFTING EYES FOR HANDLING PURPOSES

VOID TO BE FILLED WITH APPROVED NON-SHRINKING CEMENTITIOUS GROUT

VOIDS FORMED BY REMOVAL OF STEP IRONS TO BE SEALED BY APPROVED METHOD PRIOR TO FITTING OF PREFORMED LINER SEE EXISTING MH DETAILS.

EXISTING JOINTS TO BE SEALED BY APPROVED METHOD

EXISTING EPOXY MORTAR TO BE BROKEN OUT AND RENEWED

IN-SITU SEWER LINER TO BE DRESSED INTO CHASE WITH EPOXY MORTAR

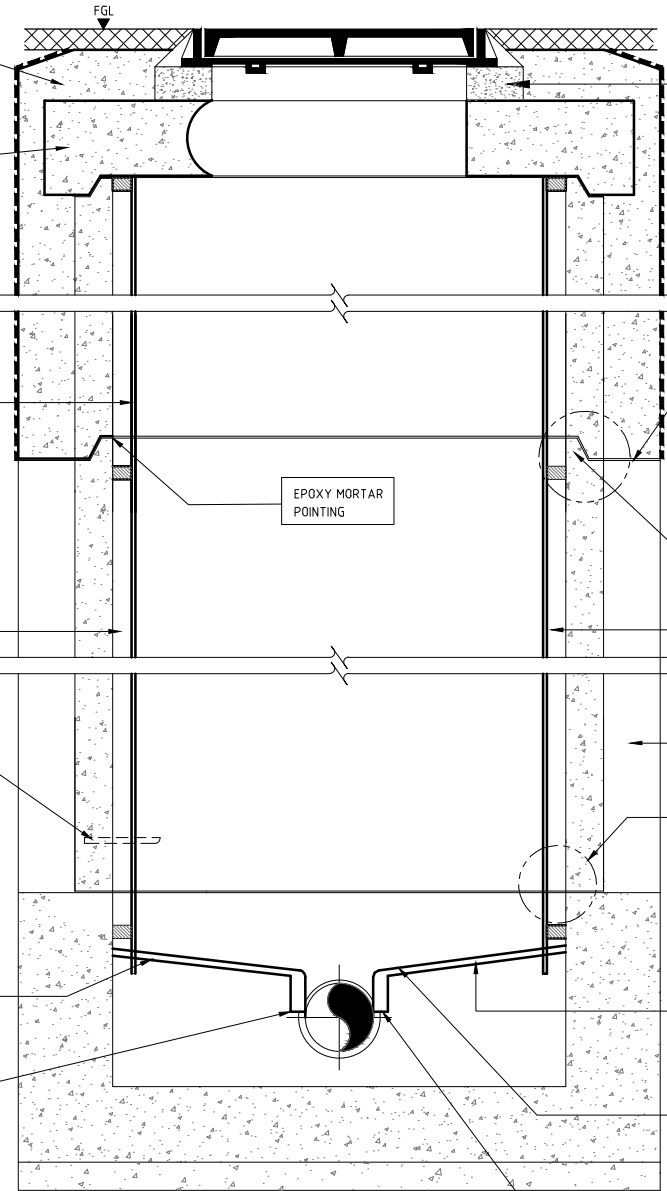

MANHOLE WITH EXISTING REDUCER SLAB AND SHAFT

NEW GRADE SRC '30' PRECAST CONCRETE BLOCK TO BE BUILT UP AS REQUIRED MAX. DEPTH 200mm

EXISTING CONCRETE SURROUND TO BE SCABBLED CLEAN TO RECEIVE NEW CONCRETE SURROUND

PROPOSED WORK
EXISTING STRUCTURE

TWO STRIPS 20 x 25 BITUMEN BASED FLEXIBLE STRIP SEALANT

EXISTING PRECAST CHAMBER RING

EXISTING CONCRETE SURROUND

EXISTING JOINTS TO BE SEALED BY APPROVED METHOD

PREFORMED LINER TO BE SEALED INTO CHASE CUT IN EXISTING BENCHING WITH EPOXY MORTAR

GRP LAMINATE APPLIED TO BENCHING AND DRESSED OVER CHANNEL LINER

CHASE 75 x 15 DEEP CUT IMMEDIATELY ABOVE SPRINGER LEVEL

NOTES:

1. ALL DIMENSIONS ARE IN MILLIMETRES UNLESS OTHERWISE STATED.
2. ALL MATERIALS AND WORKMANSHIP SHALL BE IN ACCORDANCE WITH THE CURRENT Q.C.S. UNLESS OTHERWISE AGREED WITH THE ENGINEER.
3. FOR EXISTING MANHOLE - STANDARD CONSTRUCTION DETAILS SEE DRG No. SD 8-4-201 TO SD 8-4-204.
4. SOFFIT OF PIPE ENTRY/EXIST TO BE SEALED PRIOR TO GROUTING BEHIND LINER WITH EPOXY MORTAR. GRP LAMINATE TO BE APPLIED INTEGRAL WITH BENCHING LAMINATE.
5. ALL MATERIALS AND WORKMANSHIP SHALL BE IN ACCORDANCE WITH THE CURRENT Q.C.S. UNLESS OTHERWISE AGREED WITH THE ENGINEER.
6. PROPOSED WORKS SHOWN IN BOXES ☐ FOR CLARITY.

LEGEND:

FGL FINISHED GROUND LEVEL

3	APR 19	ISSUED FOR USE	
2	01 MAR 19	REVALIDATED ISSUE	
1	03AUG15	ISSUED FOR USE	
0	15SEP13	ISSUED FOR USE	

Rev.	Date	Revision Details	Appd.
3	APR 19	ISSUED FOR USE	
2	01 MAR 19	REVALIDATED ISSUE	
1	03AUG15	ISSUED FOR USE	
0	15SEP13	ISSUED FOR USE	

QCS Section: Section 8 - Drainage Works
Part 11 - Sewer Rehabilitation

Drawing Title: EXISTING MANHOLE LINING DETAILS METHOD - A

Approved:	Sheet No: 1 OF 1
Date: APRIL 2019	Scale: 1:10 ON A1
Drawing Number: SD 8-11-101	Revision: 3